

DC Public Education Master Facilities Plan Town Hall

May 9 & 10
2023



Office of the Deputy Mayor for Education

Tasked with developing and advancing the Mayor's vision for educational and workforce excellence in Washington, DC.

Work to create a city where:

- all children, youth and adults thrive;
- every child knows joy, feels safe, and is ready to learn;
- every student attends a high-quality school; and
- every youth and adult has opportunities for strong continuing education and family-sustaining jobs.

Major DME projects for 2023

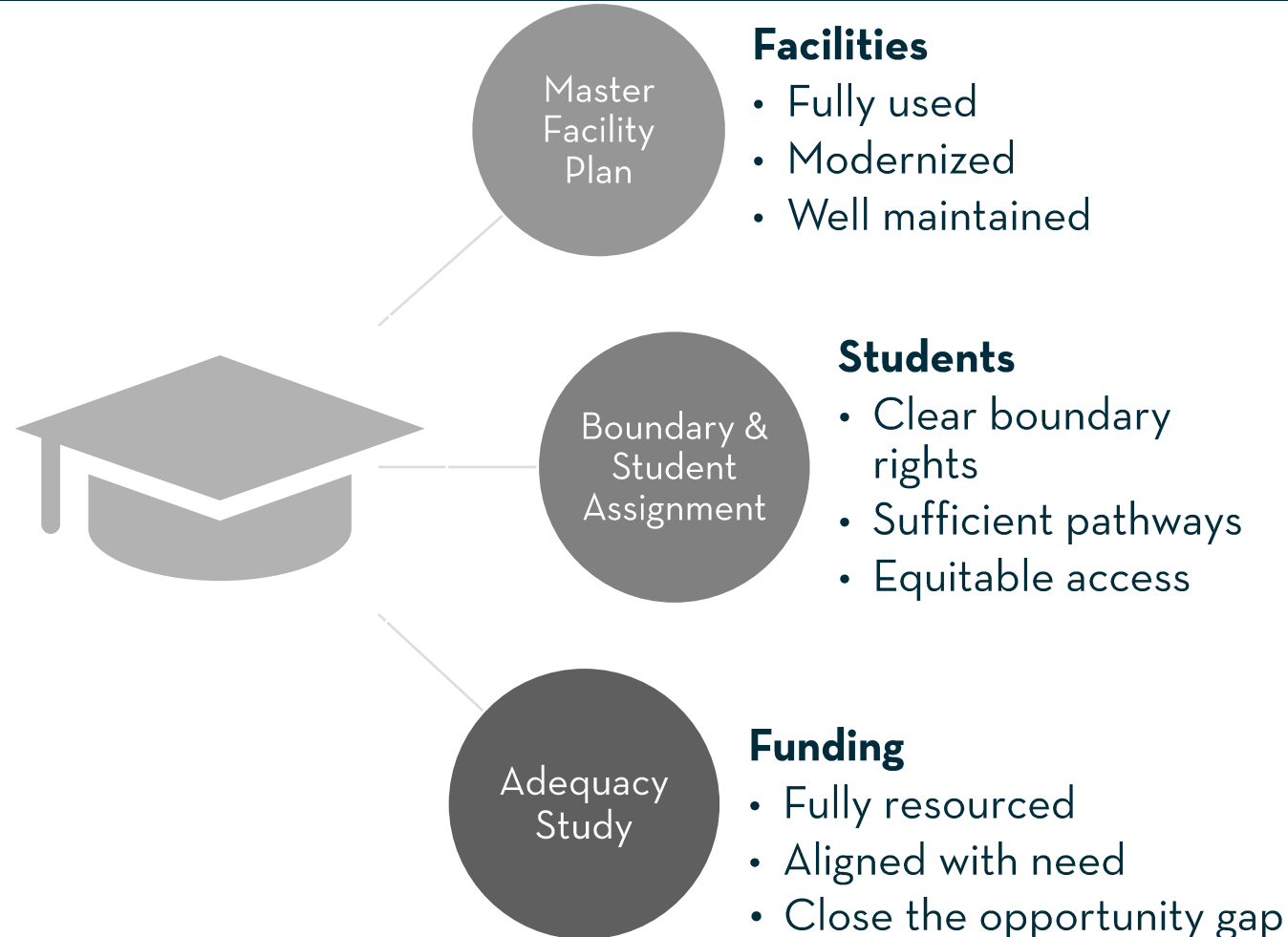

Agenda

- Welcome and team intros
- What is the Master Facilities Plan?
 - What will it accomplish?
- Foundational information to date
- What are your facility priorities?
- Next steps



Consultant team



What is the Master Facilities Plan?

The 2023 Master Facilities Plan (MFP) will be the **roadmap** to address public school facility needs through 2033. For DCPS and participating public charter schools, it will:

- Describe the physical conditions of our current public school facilities.
- Estimate future facility needs based on programs and future enrollment.
- Make recommendations to address needs.

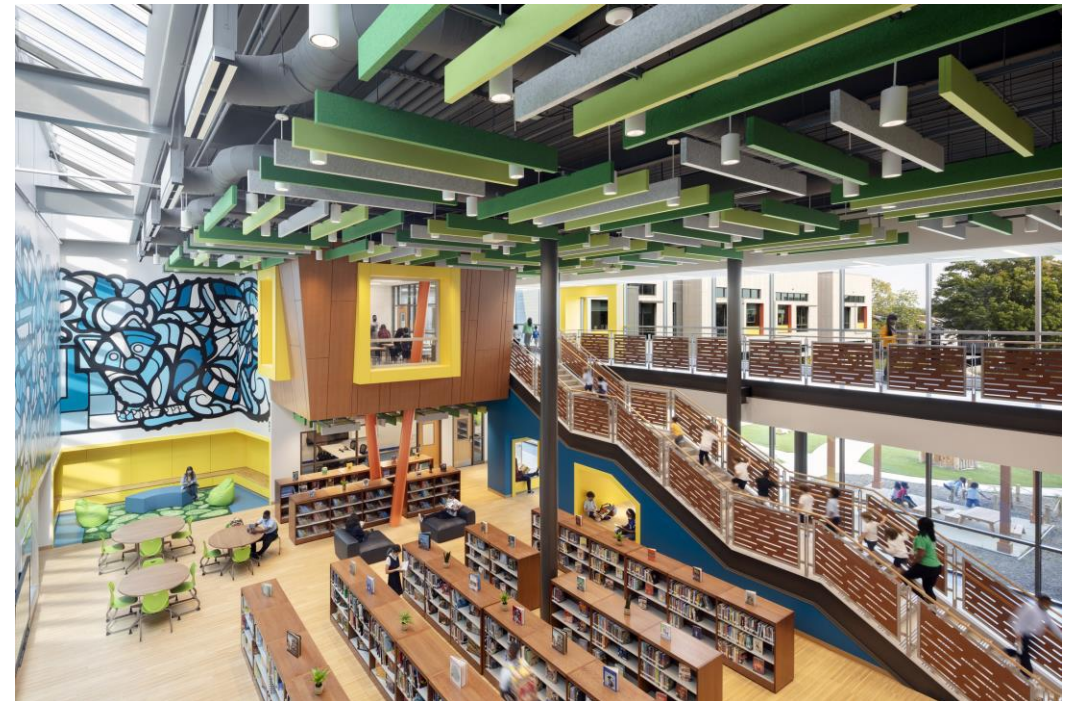

Goals of the MFP



What are the goals of the MFP?

Goal 1: Ensure school facilities are efficiently utilized.

Goal 2: Ensure every student is enrolled in a modern state of the art facility.

Goal 3: Ensure every student's daily experience is in a well-maintained facility.

Efficient utilization: What are we analyzing?

Goal 1: Ensure school facilities are efficiently utilized.

Enrollment Projections

School Programs and Room Use

Strategies to Improve Utilization

Building Capacity

Site Constraints

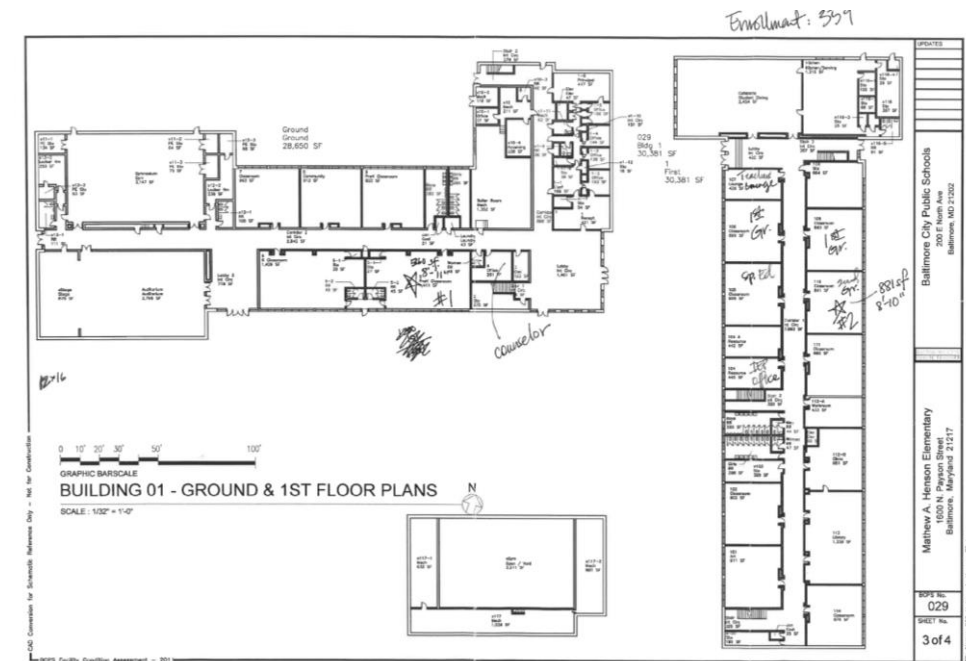

Revamped programmatic capacities

- Programmatic capacity identifies how many students could fit in a facility based on the program that is inside the facility.
- Each room that is used for full class instruction is assigned a "loading factor", or how many kids could be in each room.
 - Loading factor changes by grade and use-type.
- Support space (offices, pull out instruction spaces, etc.) and circulation square footage will also be evaluated against DCPS building program (Ed Spec) expectations.

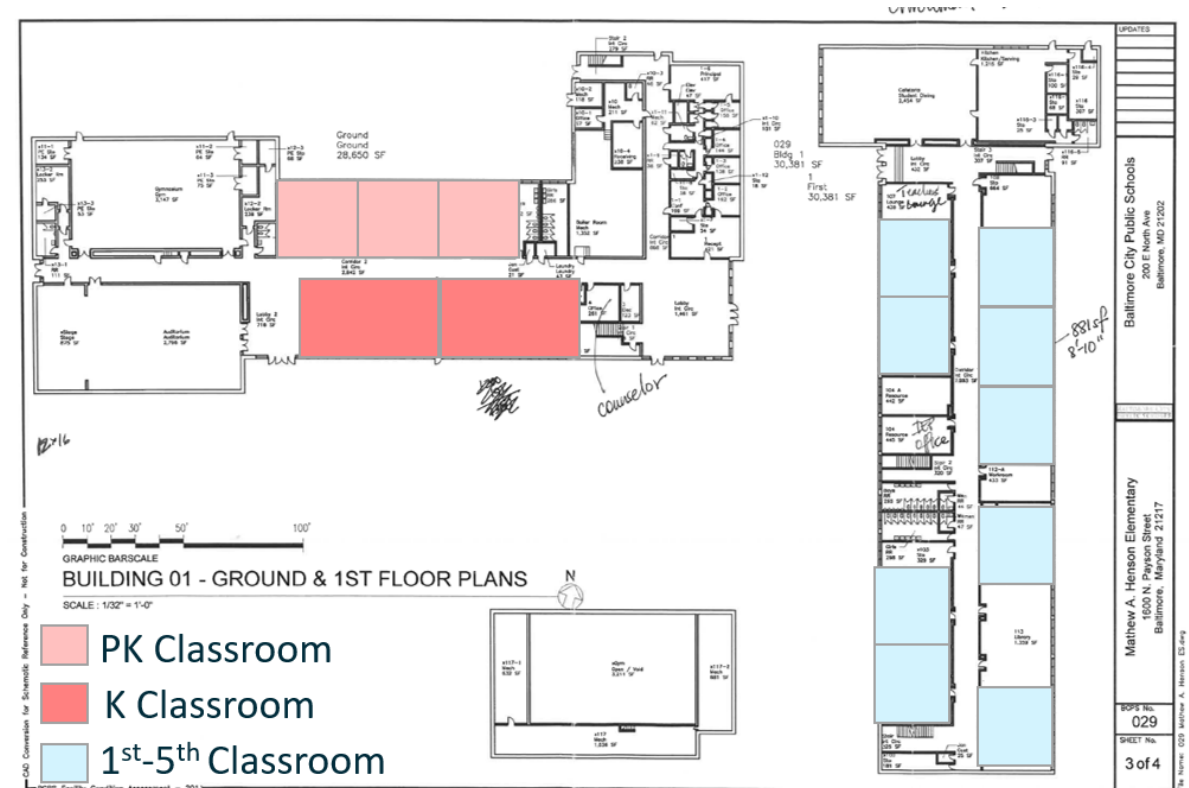

Modern facilities: What are we analyzing?

Goal 2: Ensure every student is enrolled in a modern state of the art facility.

Review of
DCPS
Capital
Spending

Evaluation of
the PACE
Act

Education
Adequacy
Evaluations

Strategies to
Improve
Capital
Planning



What does educational adequacy mean?

- Educational Adequacy measures how the architecture and layout of a facility supports 21st Century learning.
- The evaluation looks at:
 - Building presence
 - Safety and security
 - Community spaces and access
 - Assembly spaces
 - Instructional spaces
 - Staff spaces
 - Building organization
 - Extended learning opportunities



Well-maintained facilities: What are we analyzing?

Goal 3: Ensure every student's daily experience is in a well-maintained facility.

Review Facility Conditions

Evaluation of Historic Work Order Data

Funding Analysis

PM Planning



Well-maintained facilities: What are we analyzing?

Facility Evaluations

Engineers assess the District-owned facilities every 3 years to assess the **conditions** of the facilities and systems in the facility.

- System condition
- Remaining useful life
- Cost to replace

User Experience

Schools submit **work orders** to identify facility issues

- HVAC outages
- Water intrusion
- Life safety system outages

Problem Areas

Through data analysis, we will evaluate:

- Geographic trends
- Impact of the facility age
- System-level trends
- Preventative maintenance implementation.

How does the community help develop the plan?



Key facts to ground our work

- Enrollment trends
- Enrollment choices
- Schools and facilities
- Utilization



Public school enrollment increasing even after Covid

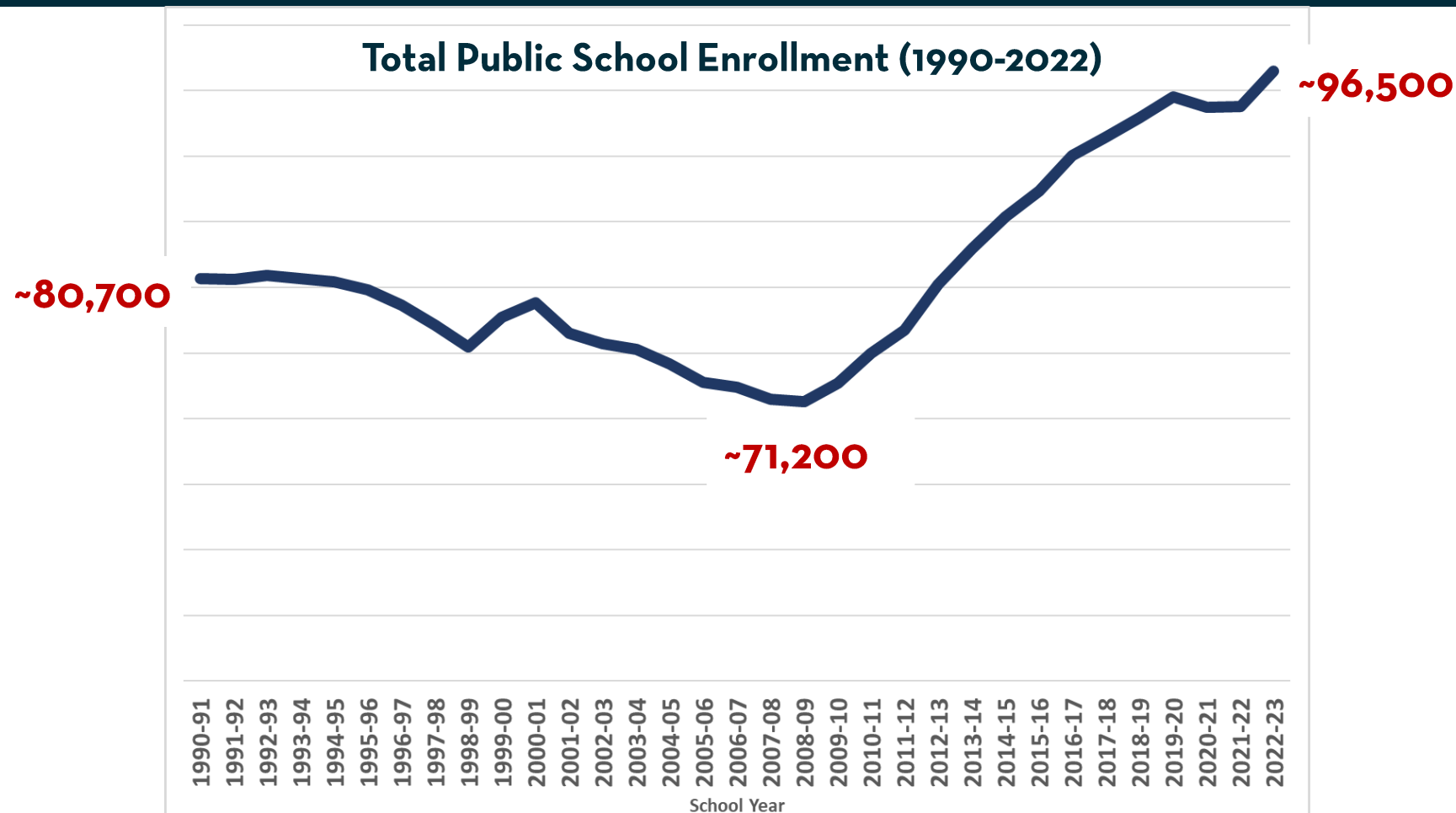

Source: OSSE audited enrollment

School enrollment increasing unevenly across the city

Enrollment Trends by Ward

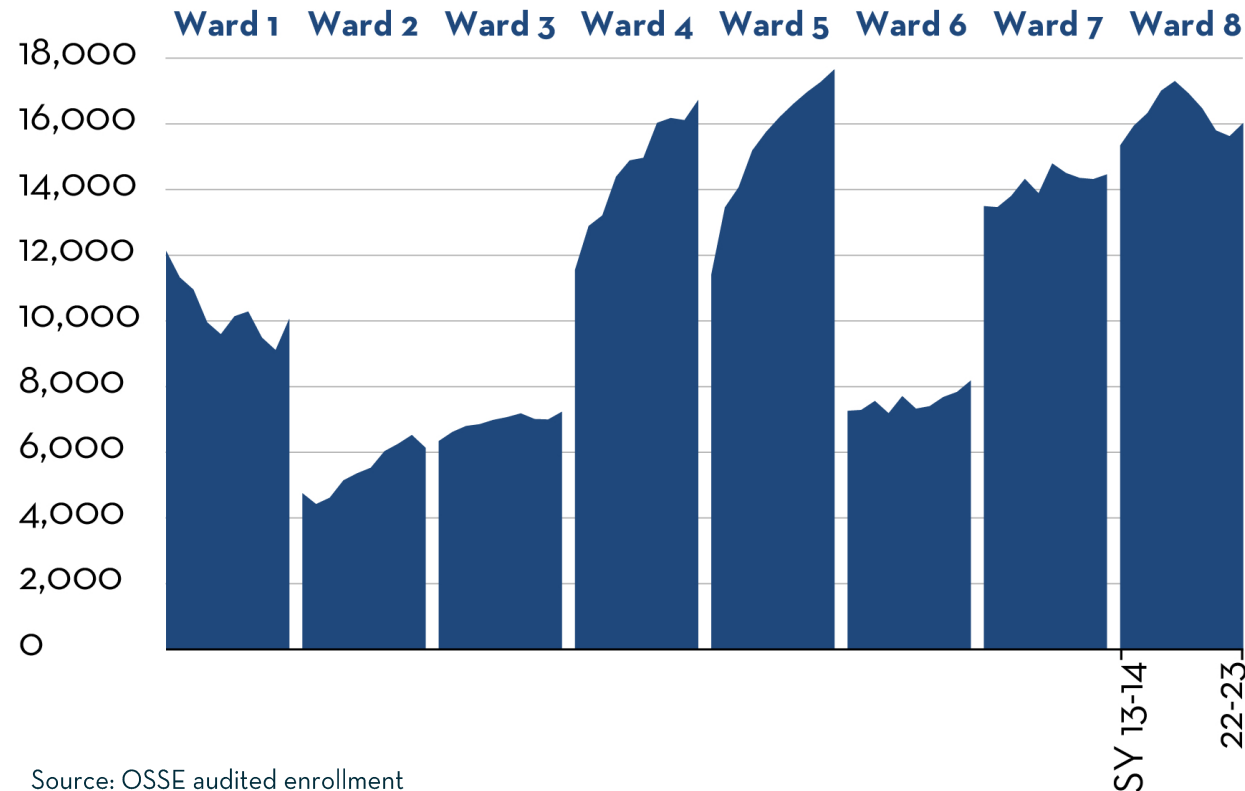

Source: OSSE audited enrollment

28% of students attend in boundary DCPS school

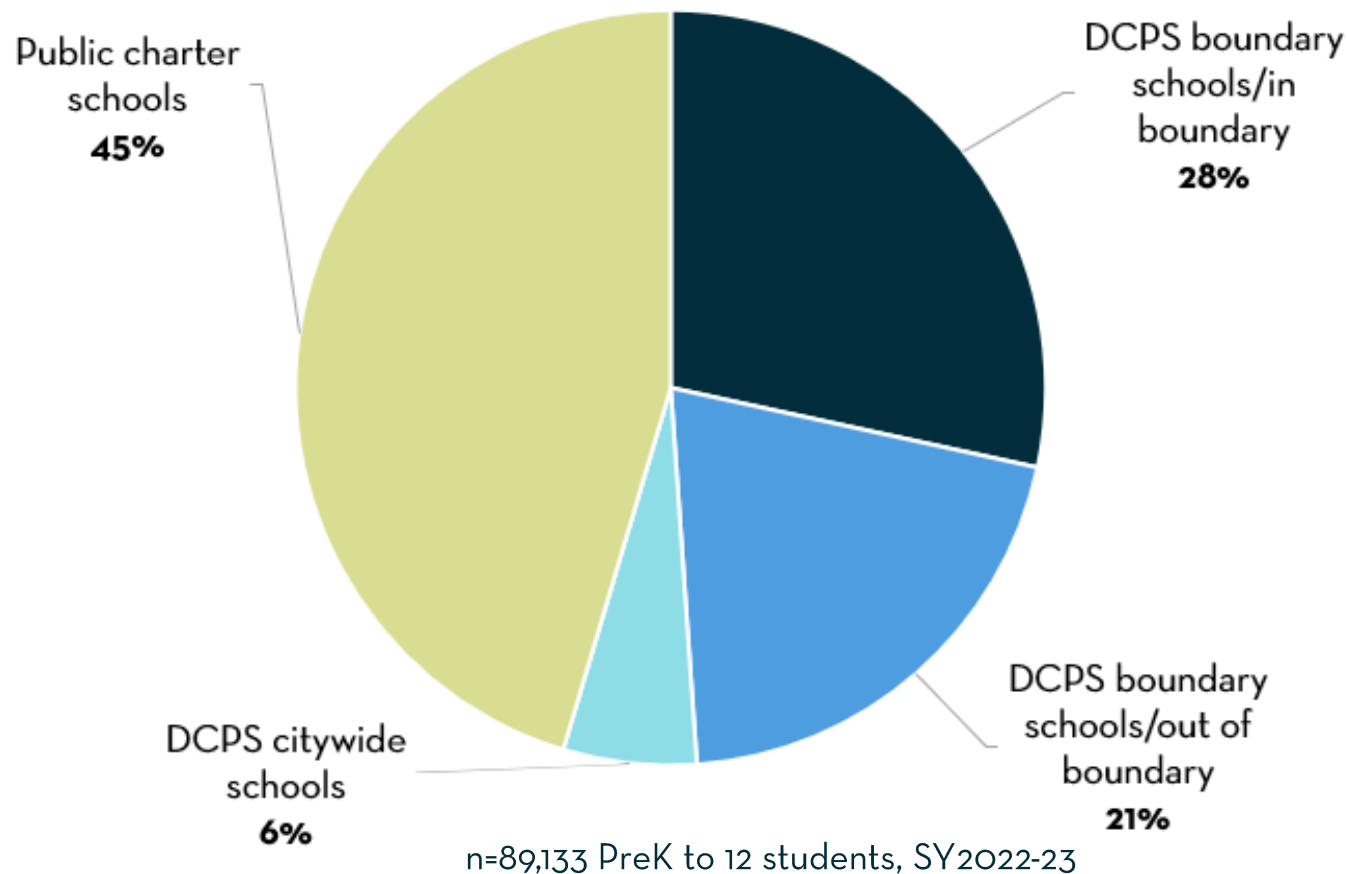

Source: DME and OSSE audited enrollment

In boundary enrollment differs by ward impacting planning

A higher proportion of students who live in **Ward 3** attend their **boundary school** than those in any other ward.

Ward 5 has the highest proportion of students who attend a **public charter school**.

Participation Type by Ward (PK-12), SY22/23

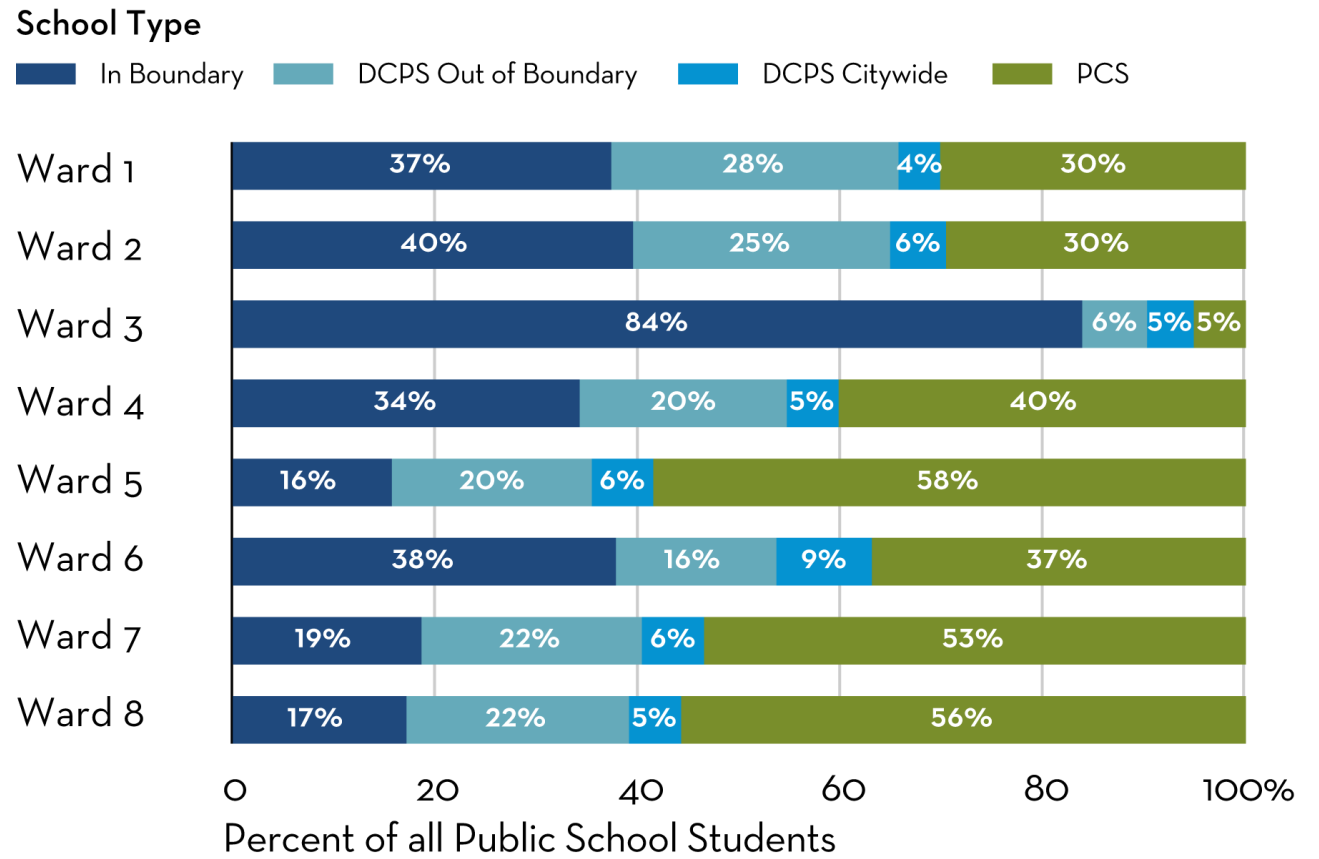

Source: DME and OSSE audited enrollment

Schools & facilities



224 facilities house 251 public schools

- 27 schools from different LEAs **co-locate** or share facilities
- 14 schools are spread out over multiple facilities (30)

DCPS facilities managed by the **Department of General Services (DGS)**

Public charters housed in **privately leased/owned buildings** and **District buildings**

Building Ownership

	# Facilities	# of Schools
District Owned - DGS		
DCPS school	113	115
DCPS/PCS colocation	1	2
PCS school	25	37
PCS/PCS colocation	7	18
Not District Owned		
PCS school - own or commercial lease	66	64
PCS school - own, former DCPS facility	8	14
PCS/PCS colocation	4	8

Source: DME and Department of General Services as of April 2023
Notes: # of schools greater than 251 because 14 schools are spread out over 30 facilities
Number of co-locations sums to 28 because 1 school spread over multiple facilities appears in two categories.

Areas of high and low utilization

SY22-23 Utilization, Total Capacity

Utilization 0-50% 50-80% 80-95% 95-120% >120%+ Schools undergoing modernization

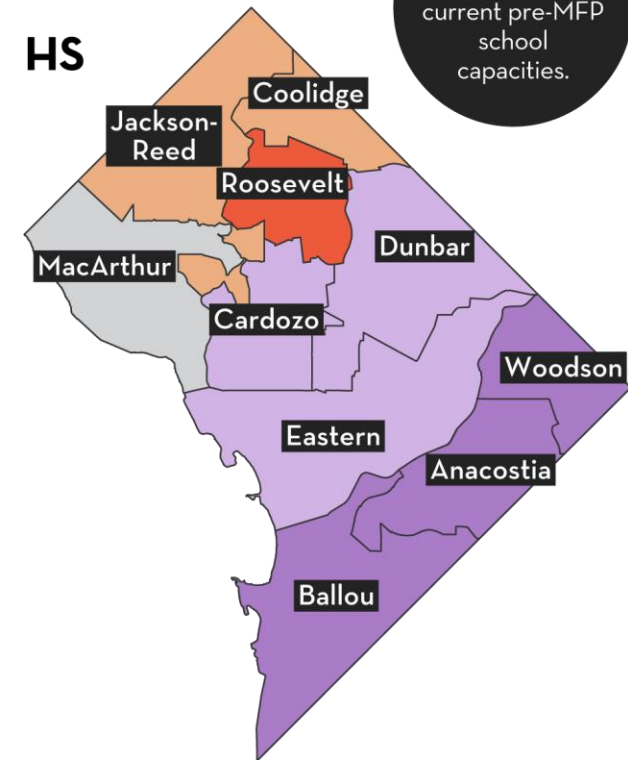
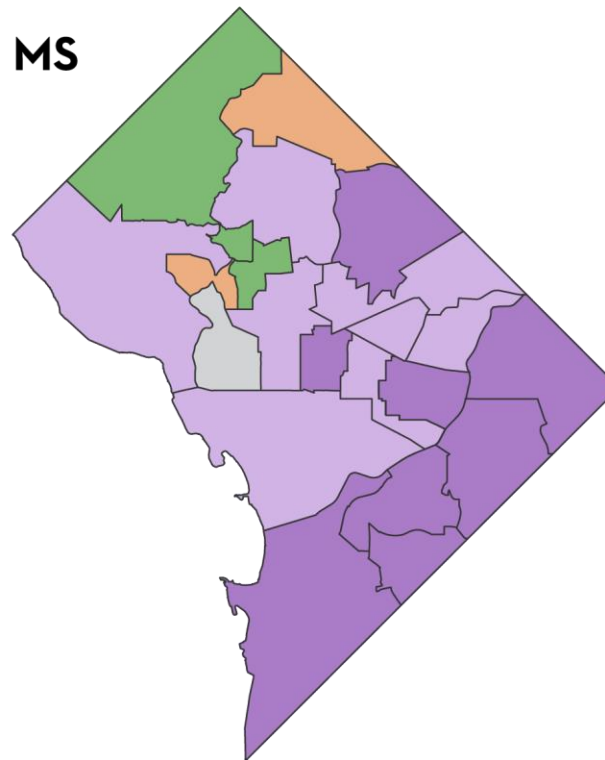
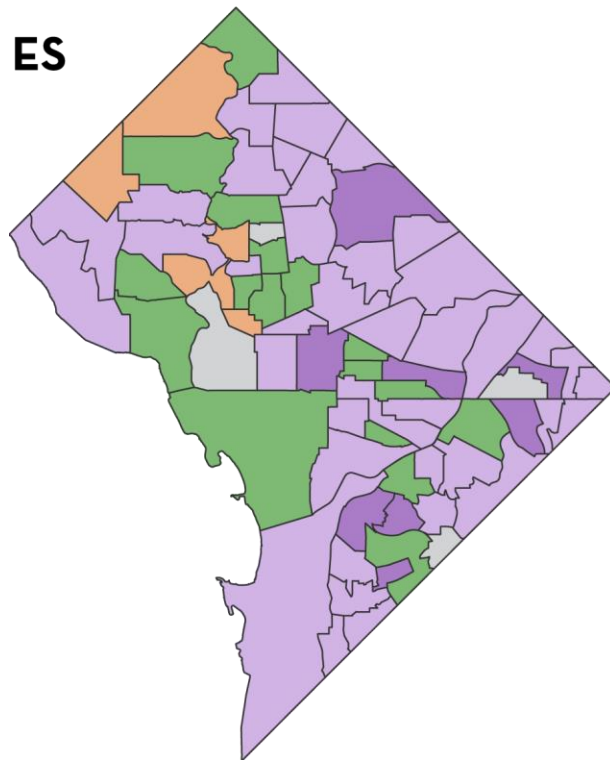

Note:
Figures based on
current pre-MFP
school
capacities.

Discussion



What should facilities do?

Please fill in the blank: *In order to provide a great learning environment and experience for students and staff, the school facility and site should ____?*

Examples:

- *Provide a safe and welcoming environment*
- *Include spaces for outdoor learning and exploration*
- Use Mentimeter to provide your response!
- Go to www.menti.com and use the code **1374 4949**



A successful plan

Please fill in the blank. This plan will be successful if it ____.

Examples:

- Identifies the most problematic facility maintenance challenges.
- Develops a plan to address overcrowding
- *Use Mentimeter to provide your response!*
- Go to www.menti.com and use the code 5551 6041



What other challenges?

- Is there anything we have overlooked?
- What challenges have you experienced with school facilities that you hope this process solves for?

Schedule



Project resources

- MFP Website for presentations, notes, and materials: <https://dme.dc.gov/mfp2023>
- Community members can submit feedback, thoughts and questions [here](#) or by scanning the QR code to the right.



Next steps

- Boundary and Student Assignment Townhalls

Tuesday, May 16 at 6 p.m. – 7:30 p.m.

Wednesday, May 17 at 6 p.m. – 7:30 p.m.

Register:

dme.dc.gov/page/townhalls-2023

- July MFP Townhalls

- Deep data dive
- Breakout discussions to understand the challenges across the district
- Preview of potential strategies